

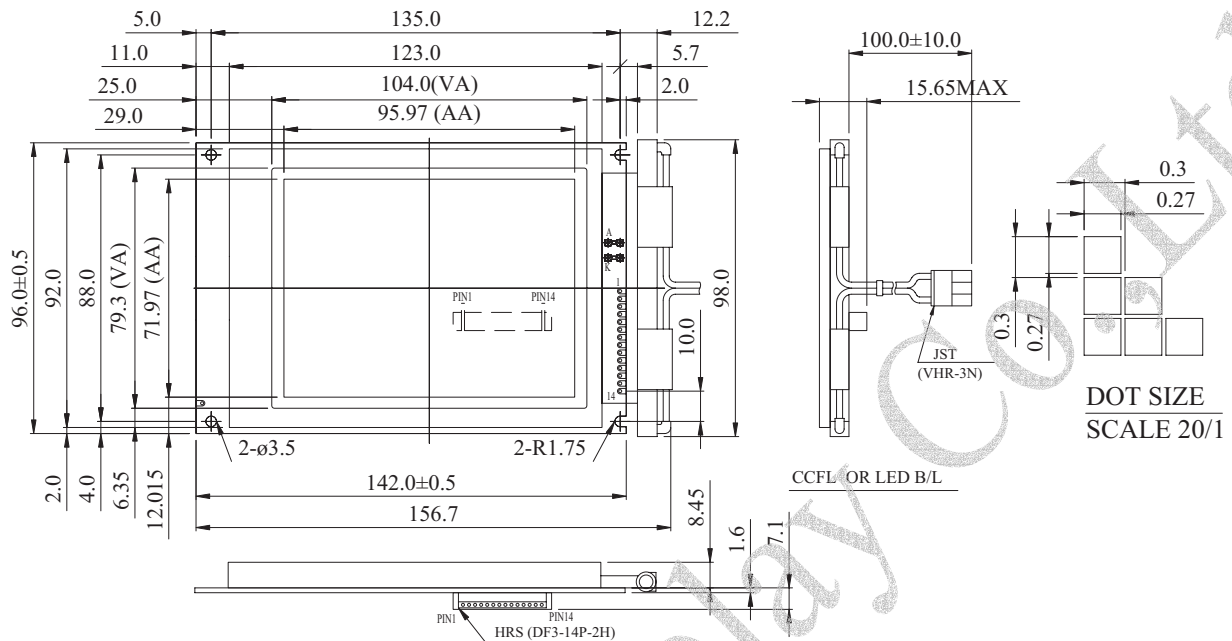

WG320240D Graphic 320x240 dots

Dimension drawing



DOT SIZE
SCALE 20/1

Graphic type

Feature

1. 320X240 dots
2. +5.0V power supply
3. 1/240 duty cycle
4. No controller
5. Touch screen option
6. Controller RA8835 optional (WG320240D0)

Mechanical Data

| Item | Standard Value | Unit |
|------------------|----------------|------|
| Module Dimension | 142.0x96.0 | mm |
| Viewing Area | 104.0x79.3 | mm |
| Mounting hole | 135.0x88.0 | mm |
| Dot Pitch | 0.30x0.30 | mm |

| Pin NO. | Symbol | Function |
|---------|----------|-------------------------|
| 1 | FRAME | First line marker |
| 2 | DF | Alternate signal |
| 3 | LOAD | Data latch |
| 4 | CP | Data shift |
| 5 | /DISPOFF | H:ON L:OFF |
| 6 | D0 | Data bus line |
| 7 | D1 | Data bus line |
| 8 | D2 | Data bus line |
| 9 | D3 | Data bus line |
| 10 | Vdd | Power supply for logic |
| 11 | Vss | Ground |
| 12 | Vee | Negative Voltage Output |
| 13 | Vo | Driving voltage for LCD |
| 14 | FG | Fix hole ground |

Absolute Maximum Rating

| Item | Symbol | Standard Value | | | Unit |
|---------------|---------|----------------|------|------|------|
| | | min. | typ. | max. | |
| Power Supply | VDD-VSS | 4.75 | 5.0 | 5.25 | V |
| Input Voltage | VI | -0.3 | --- | VDD | V |

Note: VSS=0 Volt , VDD=5.0 Volt .

Electronical Characteristics

| Item | Symbol | Condition | Standard Value | | | Unit |
|--|--------|-------------------|----------------|------|------|--------|
| | | | min. | typ. | max. | |
| Input Voltage | VDD | --- | --- | 5.0 | 5.5 | V |
| Supply Current | IDD | VDD=5V | --- | 10.0 | 15.0 | mA |
| Recommended LC Driving Voltage for Normal Temp. Version module | VDD-VO | -20°C | --- | --- | 26.1 | V |
| | | 25°C | --- | 23.8 | --- | |
| | | 70°C | 20.9 | --- | --- | |
| CCFL Starting | VFLS | 25°C | --- | 600 | --- | Vrms |
| CCFL Driving Voltage | VFLD | 25°C | --- | 268 | --- | Vrms |
| CCFL Driving Current | IFLD | VfQ=450Vrms 30KHZ | --- | 5.0 | --- | mA rms |
| LED Forward Voltage | VF | 25°C | --- | 5.0 | 5.5 | V |
| LED Forward Current | IF | 25°C | --- | 80 | --- | mA |
| EL Power Supply Current | IEF | Vel=110VAC;400Hz | --- | --- | 5.0 | mA |